



CDVI

Security to Access



2EASY



CDV-T5, CDV-T5F

**2EASY 2-Wire touchscreen multi-way
video door station**



EN

1] CONTENTS

Title	Page
2] Parts and Functions	3
3] Installation	6
4] Electric Lock Connections	7
5] System Wiring and Connections	9
6] Door Station Operations	12
7] Firmware Update	13
8] Installer Mode	13
9] Main Menu	14
10] Specifications	22

2] PARTS AND FUNCTIONS

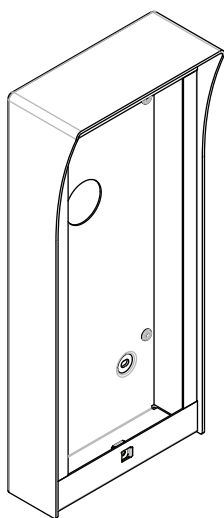
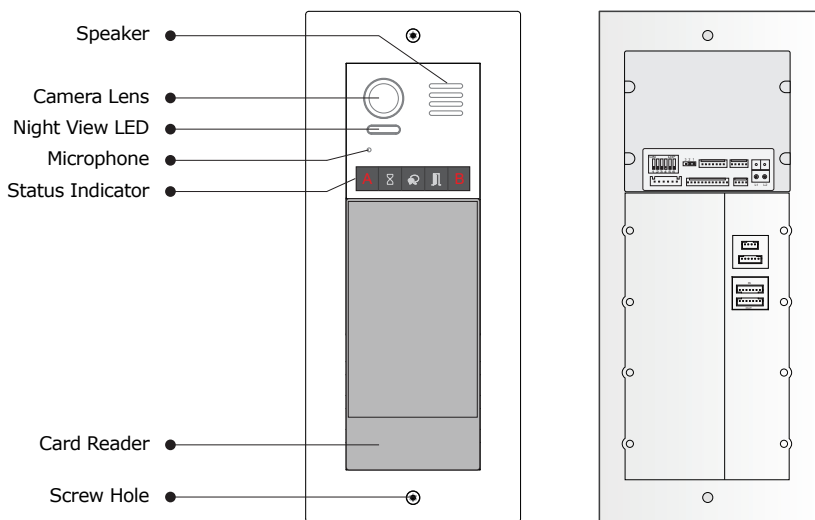

Surface housing
(CDV-T5)

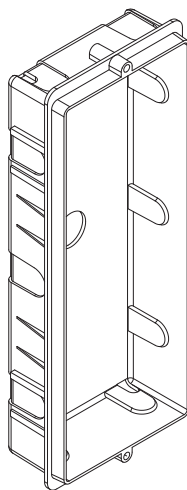

Flush housing
(CDV-T5F)

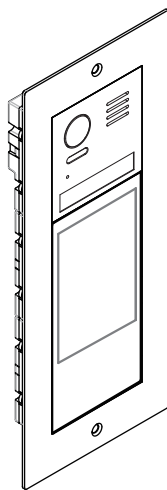

Front panel

Terminal Descriptions

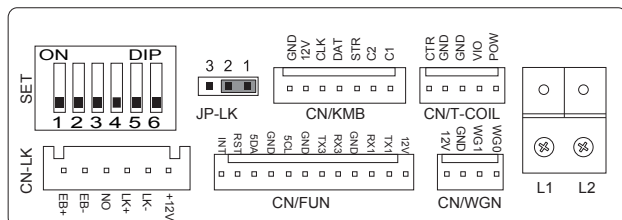

Terminal	Description
+12V	12Vdc power output
LK-	Power ground
LK+	Common contact of the relay
NO.	Normally open contact of the relay (see page 7 for lock connections)
EB+	Exit button positive connection port
EB-	Exit button negative connection port
JP-LK	For electric lock safety settings (see page 7 for lock connections)
SET	DIP switches for system configurations
CN/KMB	N/A
CN/T-COIL	N/A
CN/FUN	TFT display module connection port
CN/WGN	N/A
Bus (L1,L2)	No polarity bus line. Connect to CDV-PC9 (power combiner unit)

Door Station Module

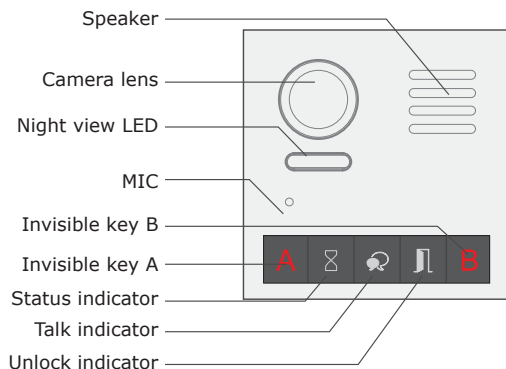

Key A and key B are not visible. See Dip Switch Settings - Bit-6.

DIP Switch Settings

A total of 6 bits can be configured by DIP switch. All switches can be modified either before or after installation. Restart the power whenever the switches have been modified.

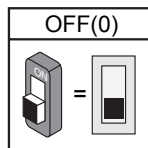
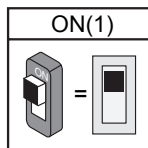

DIP	Usage	Description
Bit-1, Bit-2	Used for door station ID settings.	When multi-door stations are installed in the system, these two bits must be set correctly. The first door station is set to 00, the second to 10, the third to 01, the fourth to 11. If only one door station is installed, the bit is set to 00.
Bit-3	Not used.	0 is the default setting and the default time is 1 second. If set to 1, the unlock time is 5 seconds. (The unlock time can be modified via the door station when set to 1.)
Bit-4	Not used.	
Bit-5	Used for unlocking time setting.	
Bit-6	Used for activating the key A and key B.	Normally, key A and key B are not activated. When the touch button module is powered and Bit-6 set to 1, the keys A and B are activated.

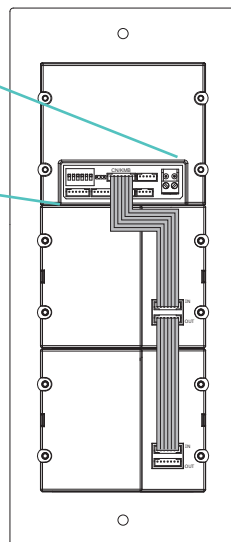
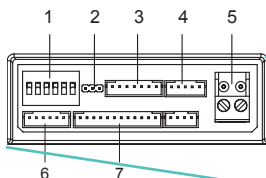

No.	Name	Description
1	SET	DIP switch for system configurations
2	JP-LK	For electric lock safety type setting
3	CN/KMB	Touchscreen module connection port
4	CN/T-COIL	Reserved
5	Bus	No polarity bus line. Connect to power combiner unit
6	CN-LK	Electric lock and exit button connection port
7	CN/FUN	TFT display module connection port

3] INSTALLATION

Flush Mount

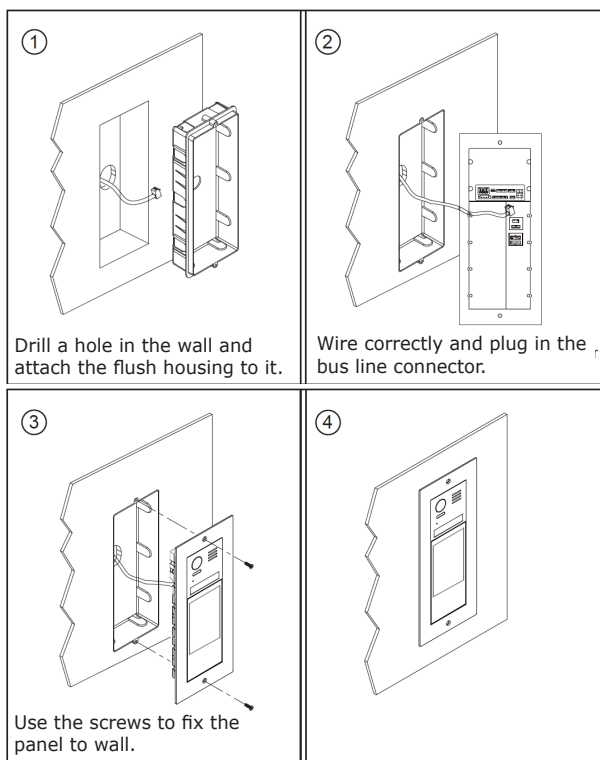

Surface Mount

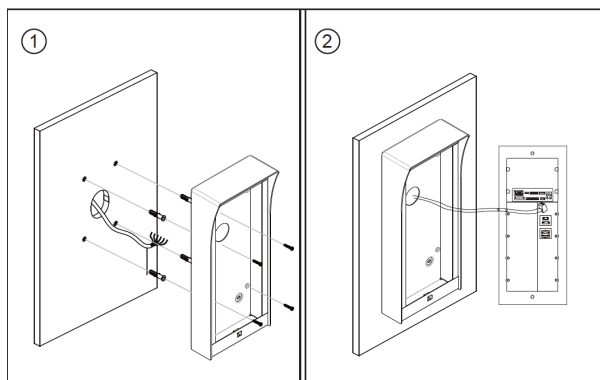

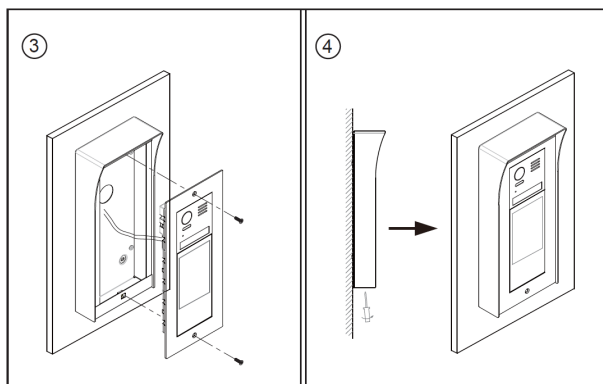

4] ELECTRIC LOCK CONNECTIONS

Door Lock Controlled with Internal Power

1. The door lock is limited to 12Vdc. The holding current must be less than 250mA when using internal power supply.
2. The monitor's **Unlock Mode** must be set to 0 (by default).
3. Set the jumper to position 1-2 for Fail Safe type locks (*Power off to unlock*). Set to position 2-3 for Fail Secure type locks (*Power on to unlock*).
4. You can change the unlocking time on the door station directly.

Fail Safe

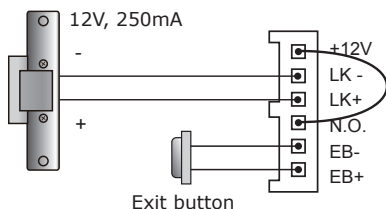

1 2 3



JP_LK

Jumper in position 1-2

Fail Secure

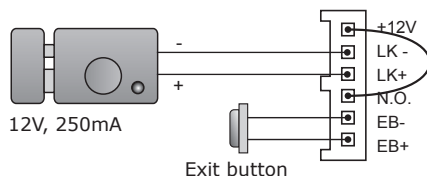

1 2 3



JP_LK

Jumper in position 2-3

Door Lock Controlled with Dry Contact

1. The external power supply must be chosen according to the lock.
2. The jumper must be taken off before connecting.
3. Set the monitor's **Unlock Mode** for different types of lock.
 - **Fail Secure** (Power on to unlock): Unlock Mode=0 (by default)
 - **Fail Safe** (Power off to unlock): Unlock Mode=1
4. You can change the unlocking time on the door station directly.

Fail Safe

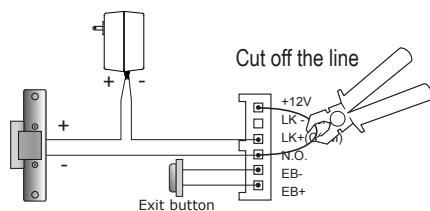

1 2 3
JP_LK

Take the jumper off

Fail Secure

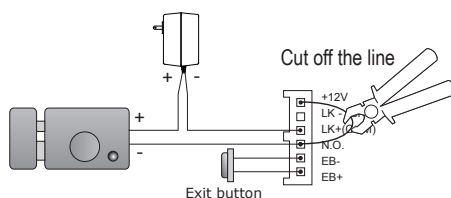

1 2 3
JP_LK

Take the jumper off

5] SYSTEM WIRING AND CONNECTIONS

Apartment View

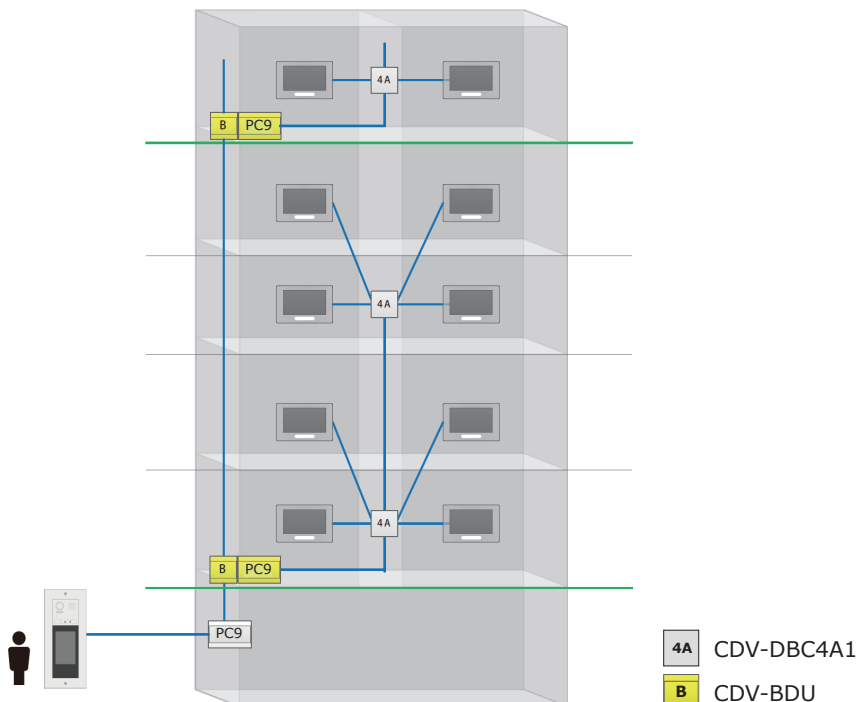

Wiring Diagram

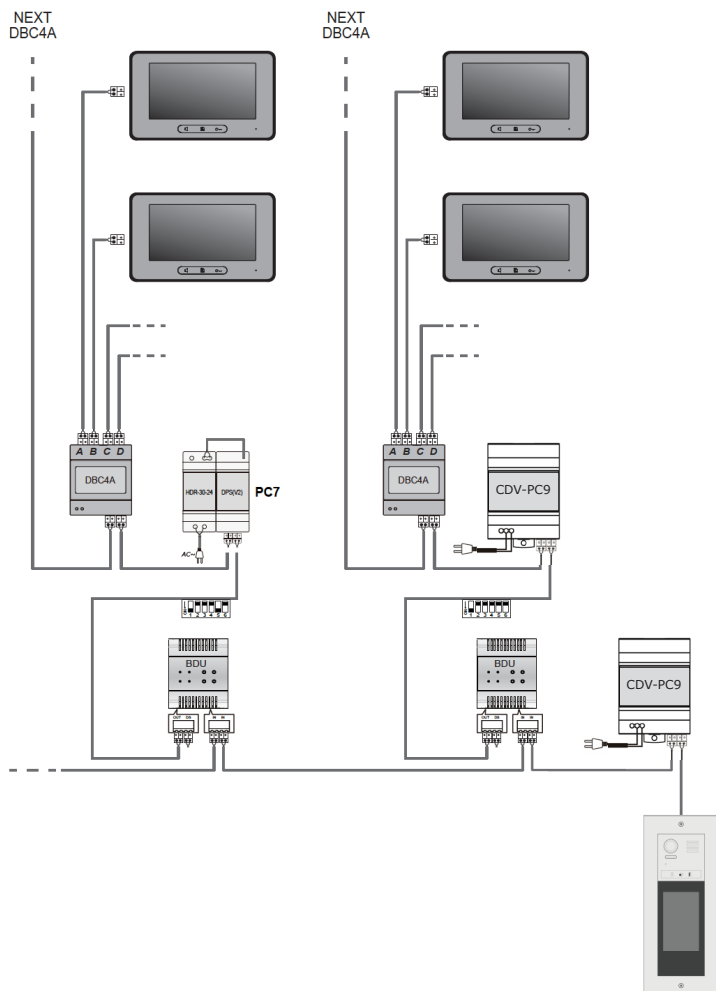

Star Typology with CDV-DBC4A1

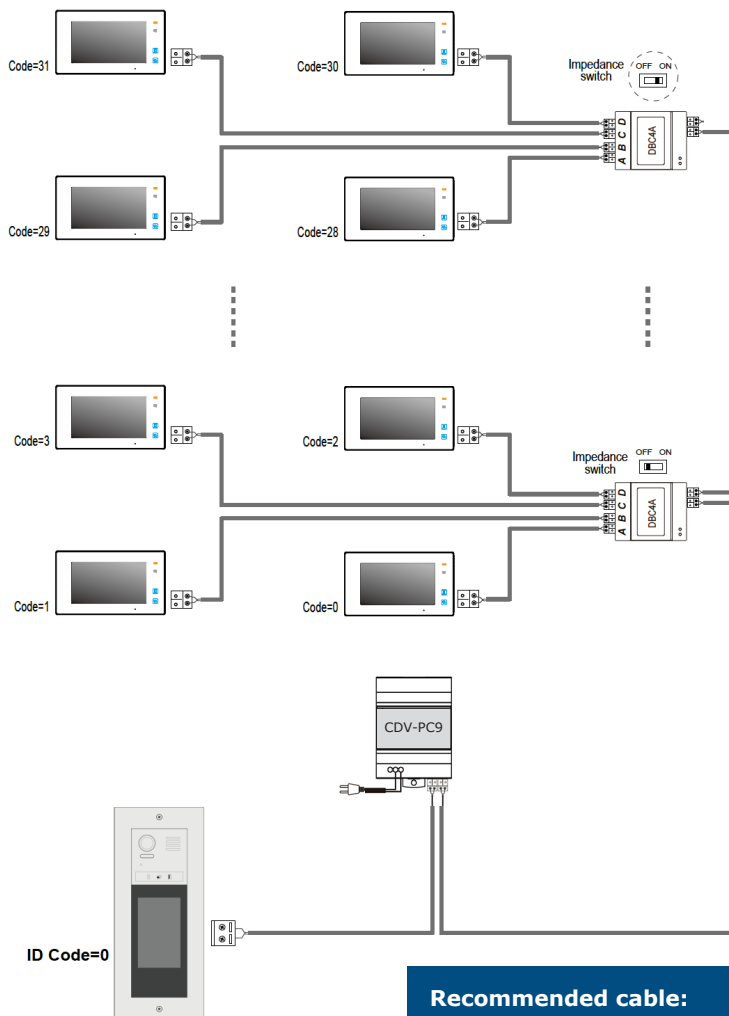

Recommended cable:
 16AWG, Belden 8471

The system can be extended by up to 3 slave monitors for each monitor. We recommend you use the CDVI distributor CDV-DBC4A for the extension.



Important:
 Subject to cable type.

For further help, call CDVI Technical Support on +44 (0) 1628 531300 or visit the [CDVI Support Centre](#).

6] DOOR STATUS OPERATIONS

Main Menu

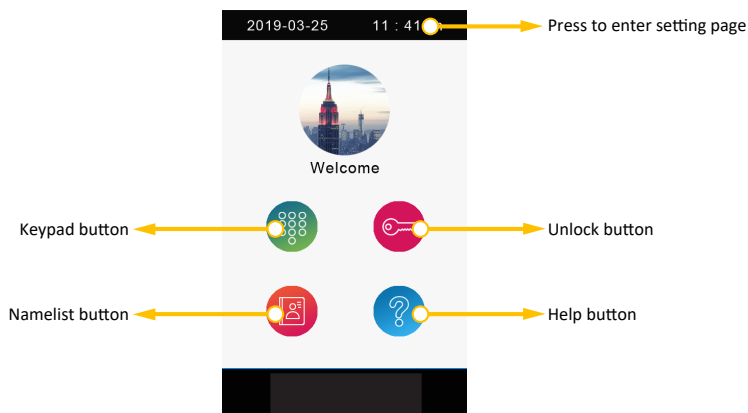

Calling a resident via room number input

1. Press the keypad button to enter the keypad page.
2. Input the room number.
3. Press  to call.

Calling a resident via namelist

1. Press the namelist button to enter the namelist page.
2. Select the desired name from the list.
3. Press  to call.

Opening the door by entering password

1. Press the unlock button to enter the keypad page.
2. Input your unlock password.
3. Press  to open the door.

Opening the door with an access card

Touch your access card to the card reader area of the door station.

7] FIRMWARE UPDATE NOTICE



If you require a firmware update, contact [CDVI Support Centre](#):
 +44 (0) 1628 531300, technical@cdvi.co.uk



8] INSTALLER MODE

Entering The Menu

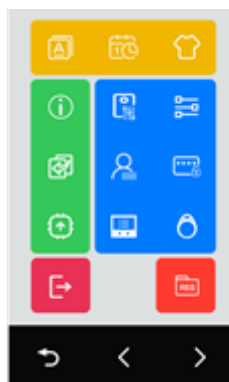
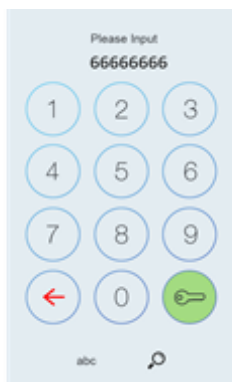
Tap  and enter the installer password on the screen.
 Default installer password: 66666666



In order to exit Installer mode, you will have to manually exit or power off the door station and restart it.

Tap  to exit Installer mode.
 Tap  to return to the main menu.

You can check if you are still in Installer mode by looking at the main menu:

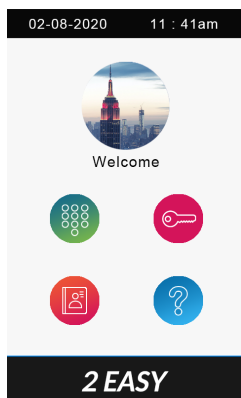

Installer mode exited

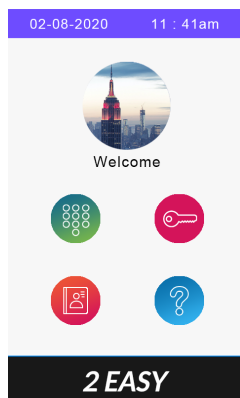

Installer mode still activated

If the door station is still in installer mode, tap the blue bar at the top to get into installer menu and exit it.



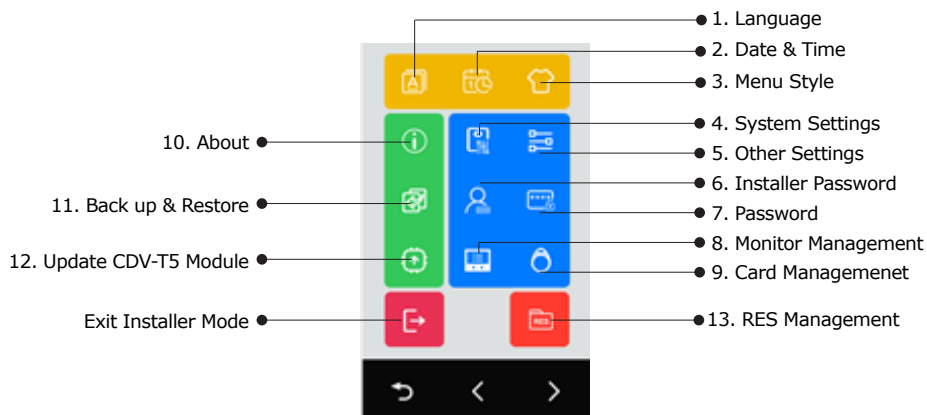

9] MAIN MENU





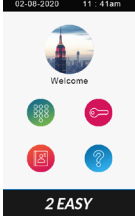

4. System Settings

Sub-menu	Description
Video Format	PAL or NTSC. Could be kept as default.
Tone Prompt	Tone or prompt setup. 0: Mute, 1: Tone, 2: English
Sound Volume	Tone or prompt volume. Beep volume: 1-9
Unlock Mode	Lock release mode: "Normally open" or "Normally closed"
Unlock Timing	Lock release time
Night LED Level	Night LED under camera illumination level
Night LED Mode	Night LED mode: "Auto" (detect each 10min), "Always On" or "Always Off"
Raincover Enable	If the CDV-T5 is surface mounted with a raincover, it adjusts to a smaller camera angle.

5. Other Settings

Sub-menu	Description
Default menus select	Default main menus when in standby: <div> <div> Room list Sorted by room number  </div> <div> Name list Sorted by name  </div> <div> Classic main menu  </div> </div>
	Display date and time in the list calling menu: <div> <div> Enabled  </div> <div> Disabled  </div> </div>
List display date time	

Sub-menu	Description
List display unlock	Display unlock icon in the list calling menu:
	<div> <div> Enabled  </div> <div> Disabled  </div> </div>
List display name only	Display name only or with a room number
	<div> <div> 1  </div> <div> 0  </div> </div>
Screen mode	Day mode: White background Night mode: Black background
Screen brightness	TFT screen illumination level
Auto call in timing	The maximum waiting time to call without a tap to confirm. (keypad calling)
Auto call min digit	The minimum digit input to call without a tap to confirm. (keypad calling)
Auto call max digit	The maximum digit input to call directly. (keypad calling)

Villa mode

The Villa Mode enables one-touch setup of 1 to 4 named buttons on the display.

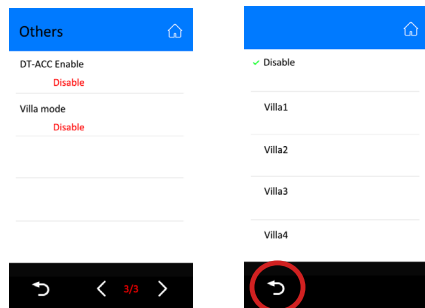

To set this mode enter the 'Other Settings' menu:

- Navigate to the end of the menu and select Villa Mode.
- Select Villa 1, Villa 2, Villa 3 or Villa 4.
- Press back.
- Press  to leave Installer Mode and set the display.

Switching Access Card Output

Setting the ACC mode allows card data to be extracted from the bus to a standard Wiegand reader port of an ACU, such as CDVI's ATRIUM system.

Note: The built-in reader is dual-technology for 125Khz Proximity Cards and 13.56Mhz for MIFARE® Classic.

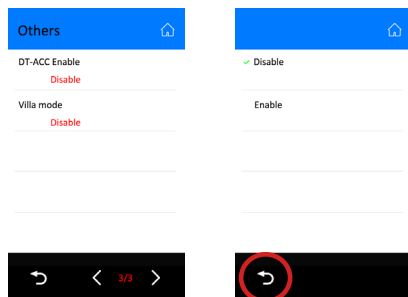

To set this mode enter the 'Other Settings' menu:

- Navigate to the end of the menu.
- Select DT-ACC and set to enabled.
- Press back
- Press  to leave Installer Mode and set the display.

6. Installer Password

Sub-menu	Action
Change installer password	Input current installer password, then input new password twice.
Default installer password	66666666

7. Password

Sub-menu	Description
Disable code unlock	When enabled, users won't be able to unlock with a password.
Change public unlock	Enter the current public unlock password, then enter the new password twice (4 digits).
Default public unlock password	1234

8. Monitor Management

This setting includes important settings:

- Namelist and name change
- Private password
- Call numbers

After getting into the monitor management menu, CDV-T5 displays as below:

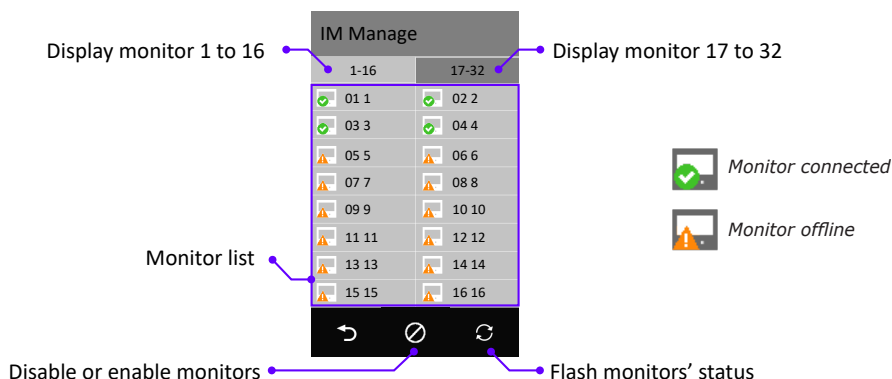

Remove or enable monitors from the namelist

By default, all 32 monitors will be listed. To remove the monitor from the list follow the steps below:

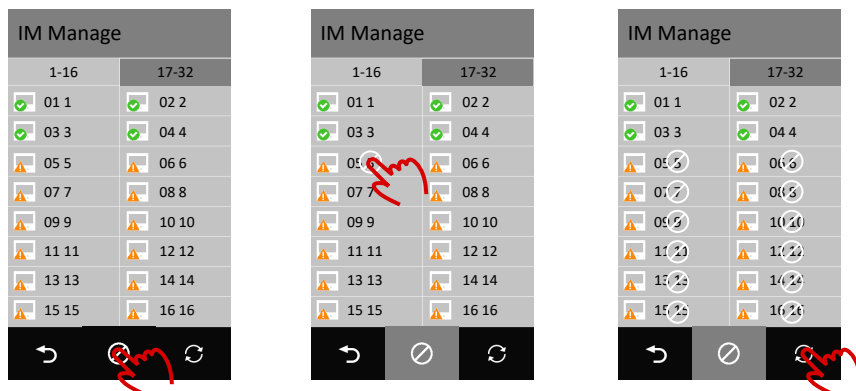

To enable removed monitors, follow the same procedure: tap the icon and tap  on the monitor that has been removed.

Manage monitors

Tap on the monitor that needs configuring as follows:

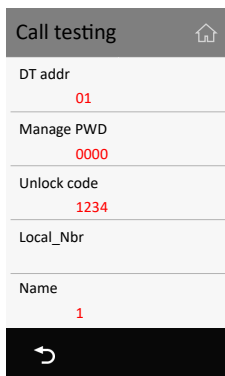
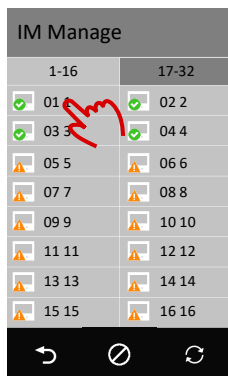

Item	Description	Example
DT addr	Current monitor address. This is read-only information.	-
Manage PWD	Password management for this user. Each user can get into their own setting menu by entering a "Manage password". Enter "Address" + "Manage password" to get into the menu.	For user 01 and password 2234, enter 12234 to enter the management page.
Unlock code	The password entered to release the door station. Enter "Address" + "Unlock Code" to unlock the door.	For door station 16 and unlock code 3324, enter 163324.
Local_Nbr	Alias dial number to call this monitor.	
Name	Name displayed in the namelist.	



For systems greater than **32 monitors**, contact [CDVI Support Centre](mailto:technical@cdvi.co.uk): +44 (0) 1628 531300, technical@cdvi.co.uk.

9. Card Management

Add Cards

Add card	
Room	01
Name	-
Card ID	-
<div>Save</div> <div>↩</div>	

Tap "Add cards".

1. Tap "Room" to select the room number to which the card belongs.
2. Enter the card holder's name or keep as default (room name).
3. Hold the card to the reader or enter the 10-digit card ID.
4. Tap "Save" to save the card.
5. Repeat steps 2 & 3 to add further cards to this room.
6. Repeat steps 1 to 5 to add cards to different rooms.





View Cards

View card	
Room	-
Name	-
Card ID	-
Date	-
<div>Search</div> <div>↩</div>	

Tap "View Cards" to display card information.

- Hold the card to the reader of which the card information you want to check
- Enter or select a room
- Enter card holder's name
- Enter card ID
- Enter Date (YYYYMMDD)
- Or tap "Search" to display all cards.

Delete Cards

Card List	
WFF 15654646516dgdsg	
Name 4546466304164611	
kkK fdfd1546462+89363	
MADF FAIJCP16456461319	
fdsac lkkjioh16546466560	
<div>↩ > 1/2 <</div>	

Delete all items

Delete single item

In the card display list,

- Tap the "bin" icon at the top to delete all cards.
- Tap the "bin" icon next to single items to delete a single card.

Card Data

Tap "Card data",

Sub-menu	Description
Backup to SD	Backup card data to SD card. It's the card in the CDV-T5 module.
Restore from SD	Restore a back up from SD card.
Clear RES Data	Delete all cards.

10. Device Information

Sub-menu	Description
Firmware version	The current firmware version of the CDV-T5.
Up time	Running time since powered up.
SN numner	The serial number of the CDV-T5.

11. Back Up and Restore

Sub-menu	Description
Backup	Backups include system settings, other settings, namelist (including private password) and call record.
Restore from backup	Restore from a backup.
Restore factory settings	Restores all settings, cards, namelist and password back to default.

12. Upgrade

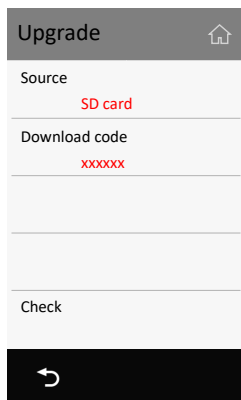

Tap to upgrade the module's firmware (core firmware).

13. RES Management

Uploads customised files: display language, default settings and logo.
 RES manage does not manage "Voice prompt".

Sub-menu	Description
Backup to SD	Backups of customised files to SD card: Display language, default settings and logo.
Restore from SD	Restore customised files.
Clean customisation	Remove customisation and revert back to the standard version.

10] PRODUCT SPECIFICATIONS

Feature	Description
Power Supply	24Vdc (supplied by CDV-PC9)
Camera	1/2.7" fisheye camera, 170° wide angle
Power Consumption	Standby: 1W, Working: 5W
Card Reader	RFID, 125KHz, 13.56MHz
Screen	5" digital colour TFT
Display Resolution	800x480 pixels
Unlock Power Ouput	250mA @ 12Vdc
Unlocking Time	1-99 sec
Operating Temperature	-10°C to 50°C
Wiring	2-wire (no polarity)
IP Protection	IP65 (screen)
Dimension	Surface: 316(H)×133(W)×48(D)mm 3gang Flush: 232(H)×133(W)×48(D)mm 2gang

Notes

This image shows a full page of white paper with horizontal dotted lines, typical of primary school writing paper. The lines are evenly spaced and run across the width of the page. There are no margins, text, or other markings on the paper.

CDVI Group

FRANCE (Headquarters)

Phone: +33 (0) 1 48 91 01 02

.....

CDVI FRANCE + EXPORT

+33 (0) 1 48 91 01 02

www.cdvi.fr

CDVI AMERICAS

+1 866 610 0102

www.cdvi.ca

CDVI BENELUX

+32 (0) 56 73 93 00

www.cdvi-benelux.com

CDVI GERMANY

+49 (0) 251 798477 0

www.cdvi.de

CDVI SUISSE

+41 (0) 21 882 18 41

www.cdvi.ch

CDVI IBÉRICA

+34 (0) 935 390 966

www.cdvi-iberica.com

CDVI ITALIA

+39 (0) 321 90 573

www.cdvi.it

CDVI MAROC

+212 (0) 5 22 48 09 40

www.cdvi.ma

CDVI NORDICS

+46 (0) 31 760 19 30

www.cdvi.se

CDVI UK

+44 (0) 1628 531300

www.cdvi.co.uk

CDVI POLSKA

+48 (0) 12 659 23 44

www.cdvi.com.pl

All the information contained within this document (pictures, drawings, features, specifications and dimensions) could be perceptibly different and can be changed without prior notice. - Aug 2024