



# 3K 4K ColorVu Bullet & Turret Camera

## User Manual

### User Manual

Thank you for purchasing our product. If there are any questions, or requests, do not hesitate to contact the dealer.

This manual applies to the models below:

Type	Model
Type I Camera	DS-2CE12KF3T-PIRXO
	DS-2CE12UF3T-PIRXO
Type II Camera	DS-2CE72KF3T-PIRXO
	DS-2CE72UF3T-PIRXO

This manual may contain several technical mistakes or printing errors, and the content is subject to change without notice. The updates will be added to the new version of this manual. We will readily improve or update the products or procedures described in the manual.

01000020241009

## About this Document

- This Document includes instructions for using and managing the Product. Pictures, charts, images and all other information hereinafter are for description and explanation only.
- The information contained in the Document is subject to change, without notice, due to firmware updates or other reasons. Please find the latest version of the Document at the Hikvision website (<https://www.hikvision.com>). Unless otherwise agreed, Hangzhou Hikvision Digital Technology Co., Ltd. or its affiliates (hereinafter referred to as "Hikvision") makes no warranties, express or implied.
- Please use the Document with the guidance and assistance of professionals trained in supporting the Product.

## About this Product

This product can only enjoy the after-sales service support in the country or region where the purchase is made.

## Acknowledgment of Intellectual Property Rights

- Hikvision owns the copyrights and/or patents related to the technology embodied in the Products described in this Document, which may include licenses obtained from third parties.
- Any part of the Document, including text, pictures, graphics, etc., belongs to Hikvision. No part of this Document may be excerpted, copied, translated, or modified in whole or in part by any means without written permission.
- **HIKVISION** and other Hikvision's trademarks and logos are the properties of Hikvision in various jurisdictions.
- Other trademarks and logos mentioned are the properties of their respective owners.

## LEGAL DISCLAIMER

- TO THE MAXIMUM EXTENT PERMITTED BY APPLICABLE LAW, THIS DOCUMENT AND THE PRODUCT DESCRIBED, WITH ITS HARDWARE, SOFTWARE AND FIRMWARE, ARE PROVIDED "AS IS" AND "WITH ALL FAULTS AND ERRORS". HIKVISION MAKES NO WARRANTIES, EXPRESS OR IMPLIED, INCLUDING WITHOUT LIMITATION, MERCHANTABILITY, SATISFACTORY QUALITY, OR FITNESS FOR A PARTICULAR PURPOSE. THE USE OF THE PRODUCT BY YOU IS AT YOUR OWN RISK. IN NO EVENT WILL HIKVISION BE LIABLE TO YOU FOR ANY SPECIAL, CONSEQUENTIAL, INCIDENTAL, OR INDIRECT DAMAGES, INCLUDING, AMONG OTHERS, DAMAGES FOR LOSS OF BUSINESS PROFITS, BUSINESS INTERRUPTION, OR LOSS OF DATA, CORRUPTION OF SYSTEMS, OR LOSS OF DOCUMENTATION, WHETHER BASED ON BREACH OF CONTRACT, TORT (INCLUDING NEGLIGENCE), PRODUCT LIABILITY, OR OTHERWISE, IN CONNECTION WITH THE USE OF THE PRODUCT, EVEN IF HIKVISION HAS BEEN ADVISED OF THE POSSIBILITY OF SUCH DAMAGES OR LOSS.
- YOU ACKNOWLEDGE THAT THE NATURE OF THE INTERNET PROVIDES FOR INHERENT SECURITY RISKS, AND HIKVISION SHALL NOT TAKE ANY RESPONSIBILITIES FOR ABNORMAL OPERATION, PRIVACY LEAKAGE OR OTHER DAMAGES RESULTING FROM CYBER-ATTACK, HACKER ATTACK, VIRUS INFECTION, OR OTHER INTERNET SECURITY RISKS; HOWEVER, HIKVISION WILL PROVIDE TIMELY TECHNICAL SUPPORT IF REQUIRED.
- YOU AGREE TO USE THIS PRODUCT IN COMPLIANCE WITH ALL APPLICABLE LAWS, AND YOU ARE SOLELY RESPONSIBLE FOR ENSURING THAT YOUR USE

CONFORMS TO THE APPLICABLE LAW. ESPECIALLY, YOU ARE RESPONSIBLE, FOR USING THIS PRODUCT IN A MANNER THAT DOES NOT INFRINGE ON THE RIGHTS OF THIRD PARTIES, INCLUDING WITHOUT LIMITATION, RIGHTS OF PUBLICITY, INTELLECTUAL PROPERTY RIGHTS, OR DATA PROTECTION AND OTHER PRIVACY RIGHTS. YOU SHALL NOT USE THIS PRODUCT FOR ANY PROHIBITED END-USES, INCLUDING THE DEVELOPMENT OR PRODUCTION OF WEAPONS OF MASS DESTRUCTION, THE DEVELOPMENT OR PRODUCTION OF CHEMICAL OR BIOLOGICAL WEAPONS, ANY ACTIVITIES IN THE CONTEXT RELATED TO ANY NUCLEAR EXPLOSIVE OR UNSAFE NUCLEAR FUEL-CYCLE, OR IN SUPPORT OF HUMAN RIGHTS ABUSES.

- IN THE EVENT OF ANY CONFLICTS BETWEEN THIS DOCUMENT AND THE APPLICABLE LAW, THE LATTER PREVAILS.

© Hangzhou Hikvision Digital Technology Co., Ltd. All rights reserved.

## Regulatory Information

### FCC Information

Please take attention that changes or modification not expressly approved by the party responsible for compliance could void the user's authority to operate the equipment.

**FCC compliance:** This equipment has been tested and found to comply with the limits for a Class A digital device, pursuant to part 15 of the FCC Rules. These limits are designed to provide reasonable protection against harmful interference when the equipment is operated in a commercial environment. This equipment generates, uses, and can radiate radio frequency energy and, if not installed and used in accordance with the instruction manual, may cause harmful interference to radio communications. Operation of this equipment in a residential area is likely to cause harmful interference in which case the user will be required to correct the interference at his own expense.

### FCC Conditions

This device complies with part 15 of the FCC Rules.

Operation is subject to the following two conditions:

1. This device may not cause harmful interference.
2. This device must accept any interference received, including interference that may cause undesired operation.

### EU Conformity Statement



This product and - if applicable - the supplied accessories too are marked with "CE" and comply therefore with the applicable harmonized European

standards listed under the Low Voltage Directive 2014/35/EU, the EMC Directive 2014/30/EU, the RoHS Directive 2011/65/EU.

2012/19/EU (WEEE directive): Products marked with this symbol cannot be disposed of as unsorted municipal waste in the European Union. For proper recycling, return this product to your local supplier upon the purchase of equivalent new

equipment, or dispose of it at designated collection points. For more information see: [www.recyclethis.info](http://www.recyclethis.info).

2006/66/EC (battery directive): This product contains a battery that cannot be



disposed of as unsorted municipal waste in the European Union. See the product documentation for specific battery information. The battery is marked with this symbol, which may include lettering to indicate cadmium (Cd), lead (Pb), or mercury (Hg). For proper recycling, return the battery to your supplier or to a designated collection point. For more information, see: [www.recyclethis.info](http://www.recyclethis.info).

**Industry Canada ICES-003 Compliance**

This device meets the CAN ICES-3 (A)/NMB-3(A) standards requirements.

**Warning**

This is a class A product. In a domestic environment this product may cause radio interference in which case the user may be required to take adequate measures.

**Safety Instruction**

These instructions are intended to ensure that user can use the product correctly to avoid danger or property loss.



The precaution measure is divided into “Warnings” and “Cautions”.

After installation, the terminal blocks for cables of this camera should be kept in a place out of reach of related personnel unless routine maintenance is performed.

Static test is not needed for the terminal blocks.

**Warnings:** Serious injury or death may occur if any of the warnings are neglected.

**Cautions:** Injury or equipment damage may occur if any of the cautions are neglected.

	
<b>Warnings</b> Follow these safeguards to prevent serious injury or death.	<b>Cautions</b> Follow these precautions to prevent potential injury or material damage.



**Warnings**

- In the use of the product, you must be in strict compliance with the electrical safety regulations of the nation and region.
- Input voltage should meet both the SELV (Safety Extra Low Voltage) and the Limited Power Source with 12 VDC according to the IEC60950-1 and IEC62368-1 standard. Refer to technical specifications for detailed information.
- The socket-outlet shall be installed near the equipment and shall be easily accessible.
- An all-pole mains switch shall be incorporated in the electrical installation of the building.
- Do not connect multiple devices to one power adapter to avoid over-heating or a fire hazard caused by overload.
- Make sure that the plug is firmly connected to the power socket.
- If smoke, odor or noise rise from the device, turn off the power at once and unplug the power cord, and then contact the service center.
- Never attempt to disassemble the camera by unprofessional personal.



## Cautions

- No naked flame sources, such as lighted candles, should be placed on the equipment.
- Install the equipment according to the instructions in this manual.
- To prevent injury, this equipment must be securely attached to the floor/wall in accordance with the installation instructions.
- Do not drop the camera or subject it to physical shock.
- Do not touch sensor modules with fingers.
- Do not place the camera in extremely hot, cold (the operating temperature shall be  $-40^{\circ}\text{C}$  to  $60^{\circ}\text{C}$ ), dusty or damp locations, and do not expose it to high electromagnetic radiation.
- If cleaning is necessary, use clean cloth with a bit of ethanol and wipe it gently.
- Do not aim the camera at the sun or extra bright places.
- The sensor may be burned out by a laser beam, so when any laser equipment is in using, make sure that the surface of sensor will not be exposed to the laser beam.
- Do not expose the device to high electromagnetic radiation or extremely hot, cold, dusty or damp environment.
- To avoid heat accumulation, good ventilation is required for the operating environment.
- Keep the camera away from liquid while in use for non-water-proof device.
- While in delivery, the camera shall be packed in its original packing, or packing of the same texture.
- The beam of the light at the distance of 200 mm is classified as Risk Group 1 (RG1). Possible hazardous optical radiation emitted from this product.
- DO NOT stare at operating light source. May be harmful to the eyes.
- Wear appropriate eye protection or turn on the supplement light only at a safe distance (0.3 m) or in the area that is not directly exposed to the light when installing or maintaining the device.

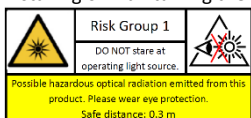

# 1 Introduction

---

## 1.1 Product Features

The main features are as follows:

- High quality imaging with 3K/4K resolution
- High performance CMOS sensor
- OSD menu with configurable parameters
- 24-hour color image
- Smart light
- 3-axis adjustment
- High quality audio with audio over coaxial cable, built-in microphone

## 1.2 Overview

### 1.2.1 Overview of Type I Camera

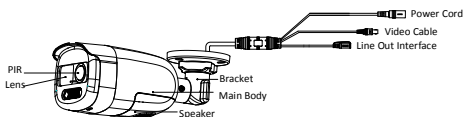

Figure 1-1 Overview of Type I Camera

### 1.2.2 Overview of Type II Camera

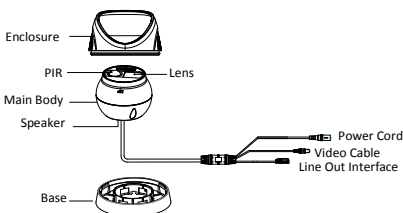

Figure 1-2 Overview of Type II Camera

## 2 Installation

### *Before you start*

- Make sure that the device in the package is in good condition and all the assembly parts are included.
- Make sure that all the related equipment is power-off during the installation.
- Check the specification of the products for the installation environment.
- Check whether the power supply is matched with your power output to avoid damage.
- Make sure the wall is strong enough to withstand three times the weight of the camera and the mount.
- If the product does not function properly, contact your dealer or the nearest service center. DO NOT disassemble the camera for repair or maintenance by yourself.

### 2.1 Installation of Type I Camera

#### 2.1.1 Ceiling/Wall Mounting without Junction Box

##### *Steps:*

1. Paste the drill template (supplied) to the installation location.
2. (Optional) For cement ceiling, drill the screw holes with a 5.5 mm drill and insert the supplied wall plugs.
3. (Optional) Drill the cable hole, when the cables are routed through the ceiling.
4. Secure the camera to ceiling with three PA4 × 25 screws (supplied).

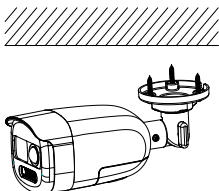

Figure 2-1 Secure the Camera to the Ceiling

5. Connect the power cord and video cable.
6. Power on the camera to adjust the view angle according to the figure below.

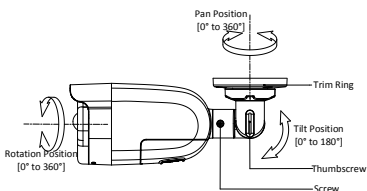

Figure 2-2 3-Axis Adjustment

### 2.1.2 Ceiling/Wall Mounting with Junction Box

#### **Before you start:**

- You need to purchase a junction box in advance.
  - Ceiling mounting and wall mounting are similar.
- Following steps take wall mounting as an example.

#### **Steps:**

1. Paste the drill template for junction box to the installation location.
2. (Optional) For cement wall, drill the screw holes with a 5.5 mm drill and insert the supplied wall plugs.
3. (Optional) Drill the cable hole, when the cables are routed through the wall.
4. Take apart the junction box.
5. Fix the camera to the junction box cover with three PM4 × 10 screws.

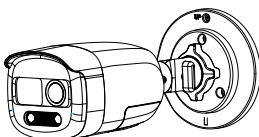

Figure 2-3 Fix the Camera to the Junction Box Cover

6. Secure the junction box body on the wall with three PA4 × 25 screws (supplied).

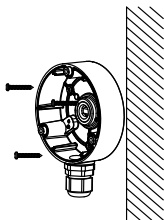

Figure 2-4 Secure the Junction Box on the Wall

7. Route the cables through the bottom cable hole or side cable hole of the junction box and connect the cables.
8. Fix the junction box cover on its body with three PM3 × 16 L6 screws.

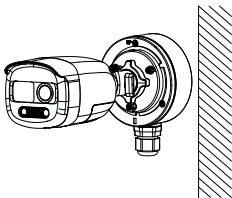

Figure 2-5 Fix the Cover to Its Body

9. Refer **Step 6** of **Section 2.1.1** to finish installation.

## 2.2 Installation of Type II Camera

### 2.2.1 Ceiling Mounting without Junction Box

#### Steps:

1. Paste the drill template (supplied) to the installation location.
2. (Optional) For cement ceiling, drill the screw holes with a 5.5 mm drill and insert the supplied wall plugs.
3. Install the camera to ceiling.
  - i. Secure the installation plate to the ceiling with three PA4 × 25 screws (supplied).
  - ii. Fit the camera onto the installation plate.
  - iii. Turn the camera as the figure below until it snaps into the installation plate.

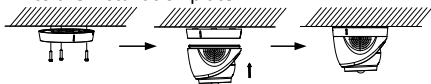

Figure 2-6 Install the Camera to Ceiling

4. Connect the power cord and video cable.
5. Power on the camera to adjust the view angle according to the figure below.

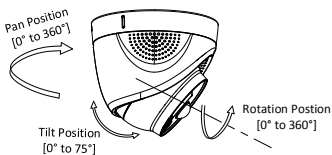

Figure 2-7 3-Axis Adjustment

- 1). Rotate the enclosure to adjust the pan position [0° to 360°].
- 2). Move the main body up and down to adjust the tilt position [0° to 75°].
- 3). Rotate the main body to adjust the rotation position [0° to 360°].

### 2.2.2 Ceiling Mounting with Junction Box

#### Before you start:

- You need to purchase a junction box in advance.
  - Ceiling mounting with a junction box is similar to ceiling mounting with an inclined ceiling mount.
- Following steps take a junction box as an example.

#### Steps:

1. Loosen screws to take apart the junction box.
2. Paste the drill template for junction box to the installation location.
3. (Optional) For cement ceiling, drill the screw holes with a 5.5 mm drill and insert the supplied wall plugs.
4. (Optional) Drill the cable hole, when the cables are routed through the ceiling.



5. Secure the junction box body on the ceiling with three or four PA4 × 25 screws according to the actual object.
6. Fix the camera to the junction box.
  - **For DS-1280ZJ-S/DS-1281ZJ-S:**

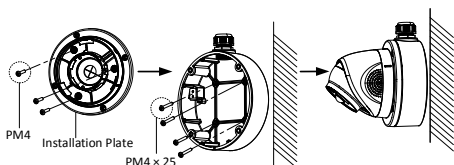

Figure 2-8 Fix the Camera to the Junction Box

- **For DS-1280ZJ-TR13**

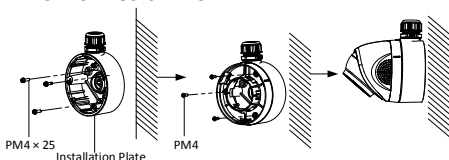

Figure 2-9 Fix the Camera to the Junction Box

7. Route the cables through the bottom cable hole or the side cable hole of the junction box.
8. Refer to **Step 5** of **Section 2.2.1** to adjust the angle and finish the installation.

### 2.2.3 Wall Mounting

#### **Before you start:**

You need to purchase a wall mount in advance.

#### **Steps:**

1. Drill  $\Phi$  10 mm screw holes in the wall where you want to install the wall mount.
2. Use four M6 expansion bolts to fix the wall mount onto the wall.

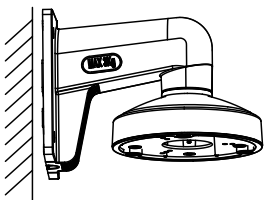

Figure 2-10 Fix the Wall Mount

3. Use three PM4 screws to fix the installation plate onto the wall mount.

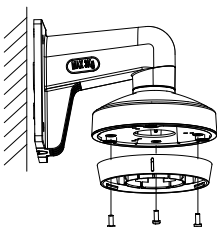

Figure 2-11 Fix the Installation Plate

4. Refer to **Steps 3 to 5** of **Section 2.2.1** to finish installation.

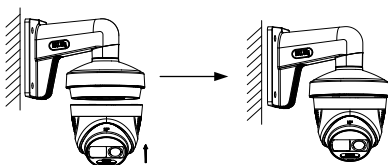

Figure 2-12 Finish Installation

## 3 Waterproof Measures

If the camera is installed outdoor, you should use the waterproof tapes to waterproof the cables. Otherwise the cables might get wet or a short circuit occurs.

**Note:**

Waterproof tapes should be purchased separately.

After routing and connecting the cables, use the waterproof tapes to wrap up the cables. Connected cables and spare cables both should be wrapped up as the figures below.

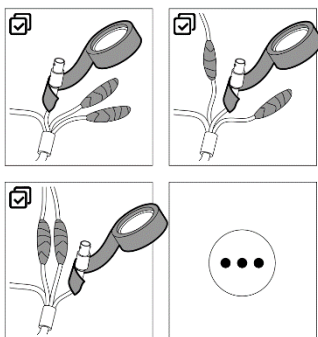

Figure 3-1 Waterproof Cable

## 4 Menu Description

Please follow the steps below to call the menu.

**Note:**

The actual display may vary with your camera model.

**Steps:**

1. Connect the camera with the TVI DVR and the monitor, as shown in figure 3-1.



Figure 4-1 Connection

2. Power on the camera, TVI DVR, and monitor to view the image on the monitor.
3. Click PTZ Control to enter the PTZ Control interface.
4. Call the camera menu by clicking  button or calling preset No. 95.

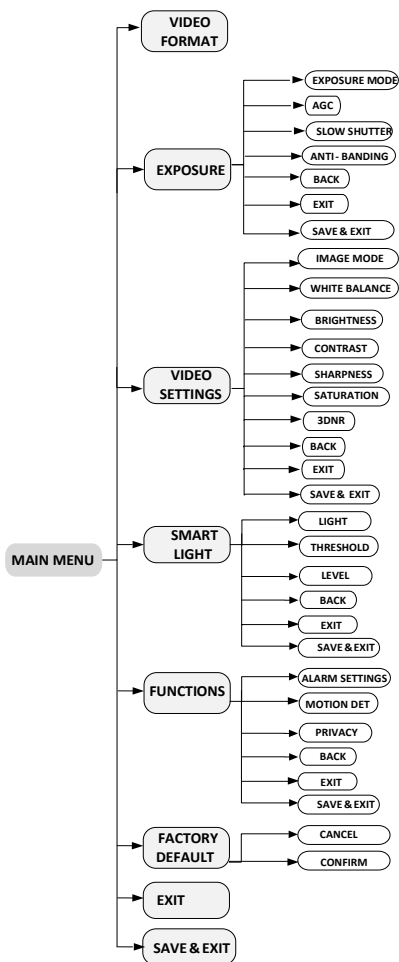

Figure 4-2 Main Menu Overview

5. Click the direction buttons to control the camera.
  - 1). Click up/down direction buttons to select menu options.
  - 2). Click Iris + to confirm the selection.
  - 3). Click left/right direction buttons to adjust the value of the selected option.

## 4.1 VIDEO FORMAT

You can set the video format to 3K@20fps (16:9 aspect ratio), 4MP@25fps, 4MP@30fps, 2MP@25fps, 2MP@30fps.

You can set the video format to 8MP@12.5fps (16:9 aspect ratio), 8MP@15fps, and 3K@20fps, 2MP@25fps, 2MP@30fps.

You can also select PAL, or NTSC in CVBS mode.

## 4.2 EXPOSURE

### EXPOSURE MODE

You can set the **EXPOSURE MODE** to **GLOBAL**, **BLC**, **HLC**, **WDR**, or **HLS**.

- **GLOBAL**

GLOBAL refers to the normal exposure mode which adjusts lighting distribution, variations, and non-standard processing.

- **BLC (Backlight Compensation)**

BLC (Backlight Compensation) compensates light to the object in the front to make it clear, but this may cause over-exposure of the background where the light is strong.

- **HLC (Highlight Compensation)**

HLC stands for highlight compensation. The camera detects strong spots (over-exposure portion of image) and reduces the brightness of strong spots to improve the overall images.

- **WDR (Wide Dynamic Range)**

The wide dynamic range (WDR) function helps the camera provide clear images even under back light circumstances. When there are both very bright and very dark areas simultaneously in the field of view, WDR balances the brightness level of the whole image and provide clear images with details.

- **HLS (Highlight Suppression)**

It is the same visual effect as the solar eclipse. If the brightness of a part in the image exceeds the threshold, this part will become black. Then whole image can be clear.

**AGC (Auto Gain Control)**

It optimizes the clarity of the image in poor light conditions. The **AGC** level can be set to **HIGH**, **MEDIUM**, or **LOW**.

**Note:**

The noise will be amplified when setting the **AGC** level.

**SLOW SHUTTER**

**SLOW SHUTTER** increases the exposure time on a single frame, which makes a camera more sensitive to the light so it can produce images even in low lux conditions.

You can set the **SLOW SHUTTER** function as OFF, x2, x4, x8, or x16(X16 is not supported under the video format of 3K@20fps) according to the different light conditions.

**Note:**

Some models support slow shutter.

**SLOW SHUTTER** is not supported by the cameras with 4K resolution.

**ANTI-BANDING**

**ANTI-BANDING** is to prevent the phenomenon of horizontal lines (banding) when photographing images in low frequency light or high brightness environments.

## 4.3 VIDEO SETTINGS

Move the cursor to **VIDEO SETTINGS** and click Iris+ to enter the submenu. **IMAGE MODE**, **WHITE BALANCE**, **BRIGHTNESS**, **CONTRAST**, **SHARPNESS**, **SATURATION**, and **3DNR** are adjustable.

VIDEO SETTINGS	
IMAGE MODE	◀ STD ▶
WHITE BALANCE	⬇
BRIGHTNESS	◀ 5 ▶
CONTRAST	◀ 5 ▶
SHARPNESS	◀ 5 ▶
SATURATION	◀ 5 ▶
DNR	◀ 5 ▶
MIRROR	◀ OFF ▶
BACK	⬆
EXIT	⬆
SAVE & EXIT	⬆

Figure 4-3 VIDEO SETTINGS

## IMAGE MODE

**IMAGE MODE** is used to adjust the image saturation, and you can set it to **STD** (Standard), **HIGH-SAT** (High Saturation), or **HIGHLIGHT** (better indoor facial details).

## WHITE BALANCE

White balance, the white rendition function of the camera, is to adjust the color temperature according to the environment. It can remove unrealistic color casts in the image. You can set **WHITE BALANCE** mode to **AUTO**, **OUTDOOR**, **GLOBAL** or **MANUAL**.

### ● MANUAL

You can set the **R-GAIN/B-GAIN** value to adjust the shades of red/blue color of the image.

WHITE BALANCE	
MODE	◀ MANUAL ▶
R-GAIN	◀ 5 ▶
B-GAIN	◀ 5 ▶
BACK	⬆
EXIT	⬆
SAVE&EXIT	⬆

Figure 4-4 WHITE BALANCE

## BRIGHTNESS

Brightness refers to the brightness of the image. You can set the brightness value from 1 to 9 to darken or brighten the image. The greater the value is, the brighter the image is.

## CONTRAST

This feature enhances the difference in color and light between parts of an image.

## SHARPNESS

Sharpness determines the amount of detail an imaging system can reproduce.

## SATURATION

Saturation is the proportion of pure chromatic color in the total color sensation. Adjust this feature to change the saturation of the color.

## 3DNR (Digital Noise Reduction)

The **3DNR** function can decrease the noise effect, especially when capturing moving images in poor light conditions and delivering more accurate and sharp image. You can set the **3DNR** value from 1 to 9.

## 4.4 SMART LIGHT

Under the **SMART LIGHT** sub-menu, you can set the mode to **OFF** or **AUTO**.

### ● OFF

Set it to **OFF** to give up this function.

- **AUTO**

You can set **THRESHOLD** and **LEVEL** in this section.

## **THRESHOLD**

The higher the threshold is, the more sensitive the device is to dark environment.

## **LEVEL**

You can adjust the maximum brightness of supplement light.

### **Note:**

If the smart light is set to OFF and the camera triggers an alarm, and if the environment is darker than the set minimum illumination threshold, the camera will automatically turn on the white light and set it to 1-level brightness.

## **4.5 FUNCTIONS**

In the **FUNCTIONS** submenu, you can set the alarm parameters, motion detection and the privacy mask of the camera.

### **4.5.1 ALARM SETTINGS**

#### **ALARM MODE**

In the **ALARM** mode, you can select the **ALARM MODE** as **SOLID**, or **FLASHING**.

- **FLASHING**

Select the **ALARM MODE** as **FLASHING**. In this way, the white light source flashes for 15 s when the PIR module receives one alarm signal.

- **SOLID**

Select the **ALARM MODE** as **SOLID**. In this way, the white light source remains on for 15 s when the PIR module receives one alarm signal.

### **Note:**

If the PIR module keeps receiving the alarm signal, both the flashing mode and the solid mode continues to alarm until the module no longer receives the alarm signal.

If both the audible alarm and the light alarm are selected on the DVR side, the end time of the light alarm keeps consistent with that of the audible alarm.

#### **PIR LEVEL**

Adjust the sensitivity of the PIR module, and the higher the value is, the more sensitive the PIR module is.

#### **PIR DET MODE**

**OUTDOOR** and **INDOOR** are selectable for PIR DET MODE switch.

#### **ALARM SOURCE**

You can set **ALARM SOURCE** as **SIREN**, **ATTENTION**, **WARNING** and **USER-DEFINED**.

### **Note:**

USER-DEFINED option appear on the interface only after the user uploads the custom voice.

#### **ALARM TIMES**

You can set **ALARM TIMES** from 1 to 5, and the default number is 3.

#### **SPEAKER**

You can set **SPEAKER** to **AUTO**, **BUILT-IN** or **EXTERNAL**.

### **AUTO:**

The built-in speaker will play the audio source if the Lineout cable is not connected to any device.

The external speaker will play the audio source if the Lineout cable is connected to an external device.

**BUILT-IN:** The built-in speaker will play the audio source.

**EXTERNAL:** The external speaker will play the audio source.

## VOLUME

You can select **VOLUME** as **LOW**, **MEDIUM** or **HIGH**.

### 4.5.2 MOTION DETECTION

In the user-defined motion detection observation area, the moving object can be detected and the alarm will be triggered. Up to 4 motion detection areas can be configured.

MOTION DET	
MODE	◀ OFF ▶
AREA 0	↶
AREA 1	↶
AREA 2	↶
AREA 3	↶
COLOR	◀ RED ▶
SENSITIVITY	◀ 5 ▶
TRANSPARENCY	◀ OFF ▶
BACK	↶
EXIT	↶
SAVE & EXIT	↶

Figure 4-5 MOTION

Select a **MOTION** area. Set the **MODE** as **ON**. Click the up/down/left/right button to define the position, and the size of the area. Set the **SENSITIVITY** from 1 to 9.

### 4.5.3 PRIVACY

The privacy mask allows you to cover certain areas which you do not want to be viewed or recorded. Up to 4 privacy areas are configurable.

PRIVACY	
MODE	◀ ON ▶
AREA 0	↶
AREA 1	↶
AREA 2	↶
AREA 3	↶
COLOR	◀ RED ▶
TRANSPARENCY	◀ OFF ▶
BACK	↶
EXIT	↶
SAVE & EXIT	↶

Figure 4-6 PRIVACY

Select a **PRIVACY** area. Set **MODE** as **ON**. Click up/down/left/right button to define the position, and the size of the area

## 4.6 FACTORY DEFAULT

Reset all the settings except video format to factory defaults.

## 4.7 EXIT

Move the cursor to **EXIT** and click Iris+ to exit the menu.

## 4.8 SAVE & EXIT

Move the cursor to **SAVE & EXIT** and click Iris+ to save the settings and exit the menu.

**UD27364B-E**