

BT7823

INTERNAL POLE JOINER FOR Ø50MM POLES

The BT7823 is an internal joining kit for Ø50mm poles which is designed to extend the drop of System 2 installations. The joiner is made from a single piece of 4mm thick heavy duty steel, which easily bolts to the inside of the poles to create a rigid, seamless join whilst still allowing cables to pass through unimpeded.

SPECIFICATIONS

Steel thickness	2mm
Width	40.6mm

FEATURES

- 1 One-piece design for a quick install
 - 2 Creates a seamless pole join
- Allows a rigid internal join of 2x Ø50mm poles
 - Heavy duty steel supports substantial loads with minimal movement
 - Allows cables to pass through the poles and joiner



BT7823

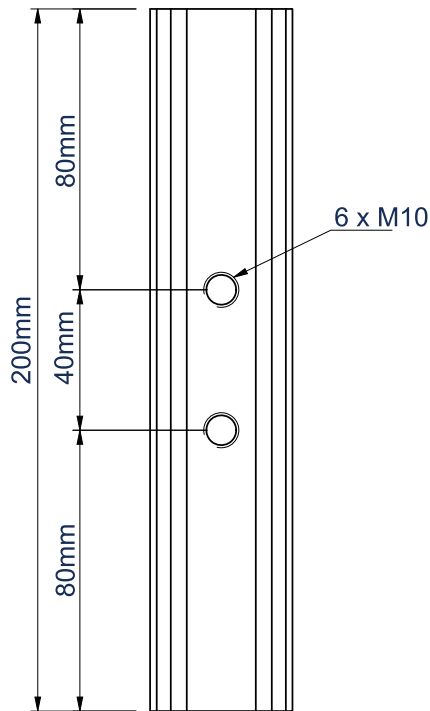

FRONT

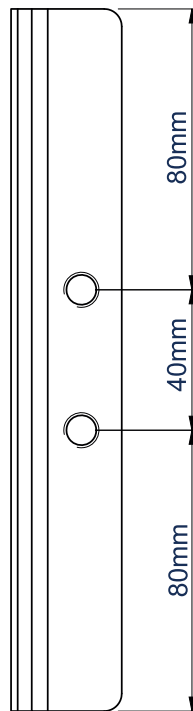

SIDE

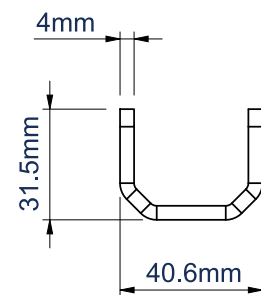

TOP

ORDERING INFORMATION

COLOUR	ORDER REF	EAN
Zinc	BT7823/Z	5019318756030

RELATED PRODUCTS

PRODUCT CODE	NAME	DESCRIPTION
BT7850	Ø50mm Poles	With up to 3m in length
BT7822	Heavy Duty Ceiling / Floor Mount	Designed for use with Ø50mm poles
BT7807	Heavy Duty Twin Ceiling / Floor Mount	Designed for use with Ø50mm poles
BT7824	External Pole Joiner	Joins 2x BT7850 poles together